

**KEY**

- **PROPOSED NO WAITING AT ANY TIME**
- SA — **PAY & DISPLAY PARKING MONDAY-SATURDAY 08.00-20.00 2hrs NO RETURN 1hr and PERMIT HOLDERS**
- SB — **PAY & DISPLAY PARKING MONDAY-SATURDAY 08.00-18.00 2hrs NO RETURN 1hr and PERMIT HOLDERS**
- PH — **PARKING MONDAY-SATURDAY 08.00-20.00 PERMIT HOLDERS ONLY**
- ◆ **PROPOSED LOCATION OF PARKING METER**
- ~ **REVOCAION OF EXISTING WAITING, LOADING AND PARKING RESTRICTIONS (NOT VISIBLE IF UNDER PROPOSALS)**
- **EXISTING WAITING, LOADING AND PARKING RESTRICTIONS (WITH OR WITHOUT SYMBOLS)**

CONTROLLED PARKING ZONE A

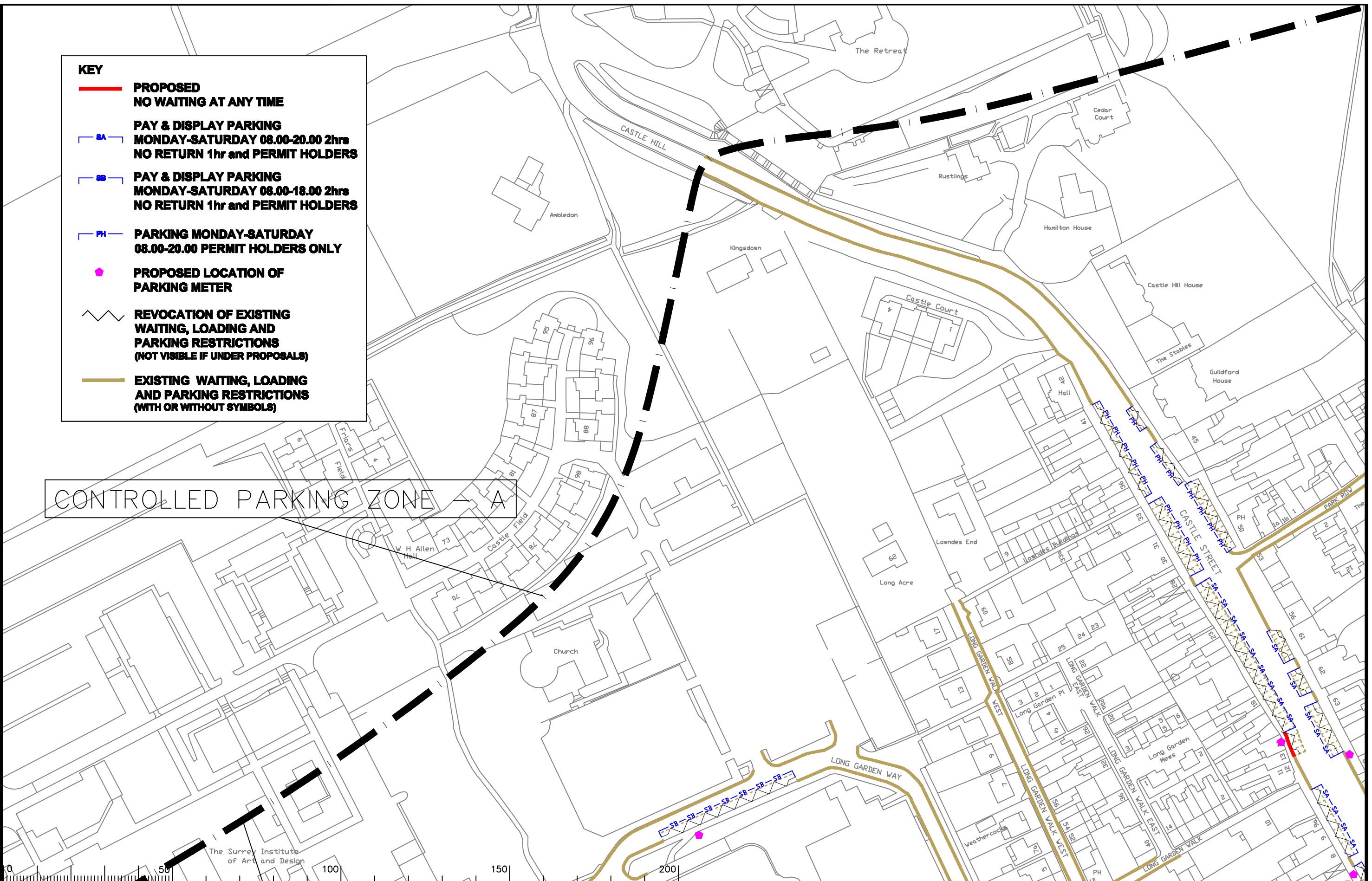

Notes

Rev.	Description	Drwn	Sig.	Date	Chkd	Sig.	Date	Appr	Sig.	Date
A	SYMBOLS ADDED TO RESTRICTIONS	SDC	SDC	23.01.08	TPC	TPC	23.01.08	TPC	TPC	23.01.08
B	RESTRICTIONS AMENDED	CAH	CAH	09.11	JAR	JAR	09.11	TPC	TPC	09.11
C	RESTRICTIONS AMENDED	CAH	CAH	09.11	JAR	JAR	09.11	TPC	TPC	09.11

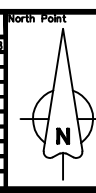

Based upon the Ordnance Survey mapping with the permission of the Controller of Her Majesty's Stationary Office. © Crown copyright. Unauthorised reproduction infringes Crown copyright and may lead to prosecution or civil proceedings. Surrey County Council I.A. 07/972-1999.

Drawn by: SDC, Sig: SDC, Date: 03.07  
 Checked by: TPC, Sig: TPC, Date: 03.07  
 Approved by: TPC, Sig: TPC, Date: 03.07

Project: **WAVERLEY DPE FARNHAM**

Drawing: **IMPLEMENTED TRAFFIC ORDERS**

Scale: 1:1250

Project No: **3282/WAV**

Contract Sheet No: **24.017**

Rev: **C**

**SURREY COUNTY COUNCIL**  
 Sustainable Development  
 Head of Transportation  
 (01253) 836100 City Hall, Farnham

Classification: **ADVERTISED**

SHEET OF

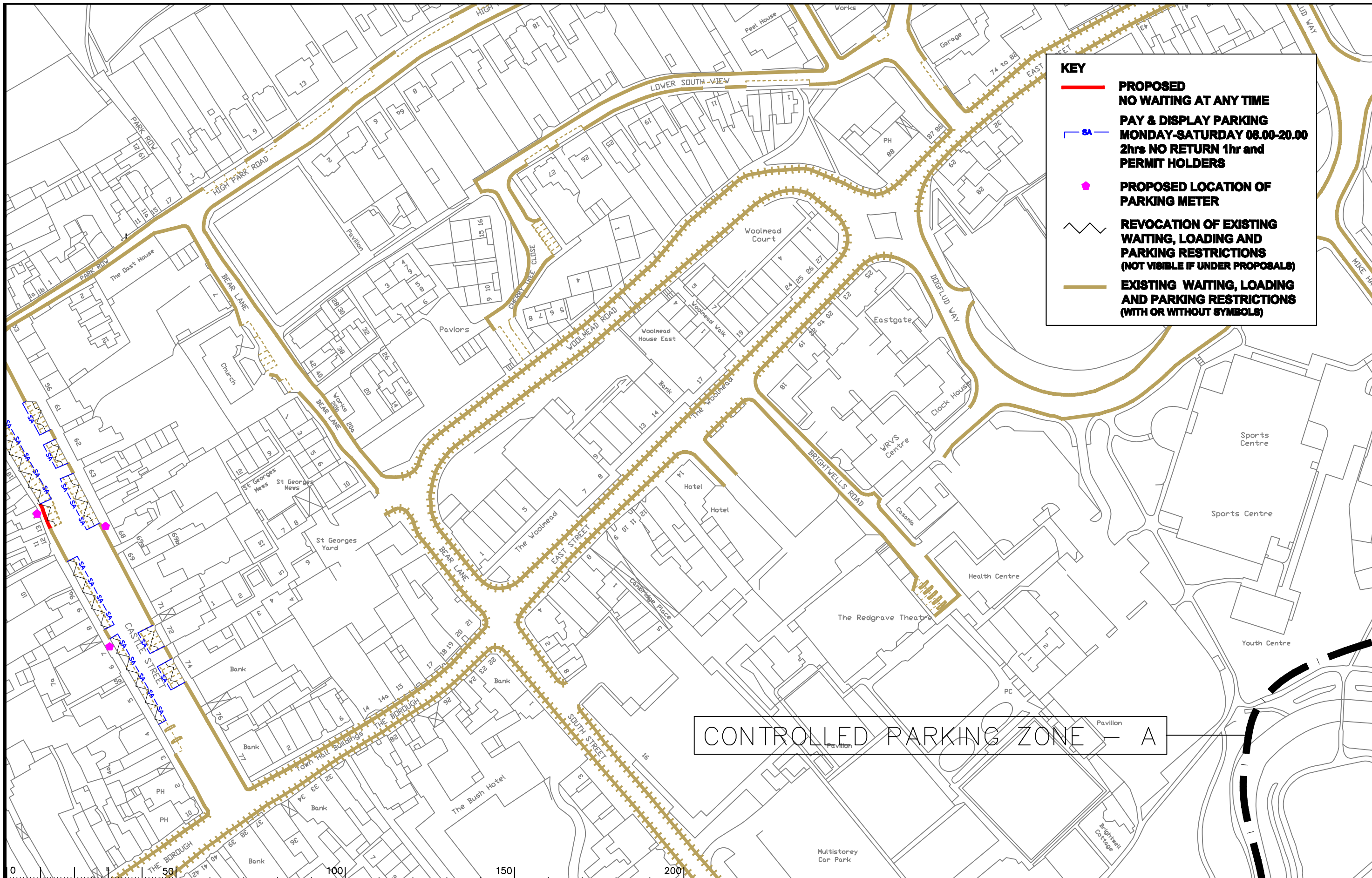

**KEY**

- **PROPOSED NO WAITING AT ANY TIME**
- SA — **PAY & DISPLAY PARKING MONDAY-SATURDAY 08.00-20.00 2hrs NO RETURN 1hr and PERMIT HOLDERS**
- ◆ **PROPOSED LOCATION OF PARKING METER**
- ⋈ **REVOCAION OF EXISTING WAITING, LOADING AND PARKING RESTRICTIONS (NOT VISIBLE IF UNDER PROPOSALS)**
- **EXISTING WAITING, LOADING AND PARKING RESTRICTIONS (WITH OR WITHOUT SYMBOLS)**

CONTROLLED PARKING ZONE — A

Notes

Rev.	Description	Drwn	Sig.	Date	Chkd	Sig.	Date	Appr	Sig.	Date
A	SYMBOLS ADDED TO RESTRICTIONS	SDC	SDC	23.01.08	TPC	TPC	23.01.08	TPC	TPC	23.01.08
B	RESTRICTIONS AMENDED	SDC	SDC	10.09	TPC	TPC	10.09	TPC	TPC	10.09
C	RESTRICTIONS AMENDED	CAH	CAH	08.11	JAR	JAR	08.11	TPC	TPC	08.11

North Point

Based upon the Ordnance Survey mapping with the permission of the Controller of Her Majesty's Stationary Office. © Crown copyright. Unauthorised reproduction infringes Crown copyright and may lead to prosecution or civil proceedings. Surrey County Council I.A. 072972-1999.

Drawn by	Sig.	Date
SDC	SDC	03.07

Checked by	Sig.	Date
TPC	TPC	03.07

Approved by	Sig.	Date
TPC	TPC	03.07

Project: **WAVERLEY DPE FARNHAM**

Drawing: **IMPLEMENTED TRAFFIC ORDERS**

Scale: 1:1250

Project No. **3282/WAV**

Contract Sheet No. **24018**

Rev. **C**

**SURREY COUNTY COUNCIL**  
Sustainable Development

Classification: **ADVERTISED**

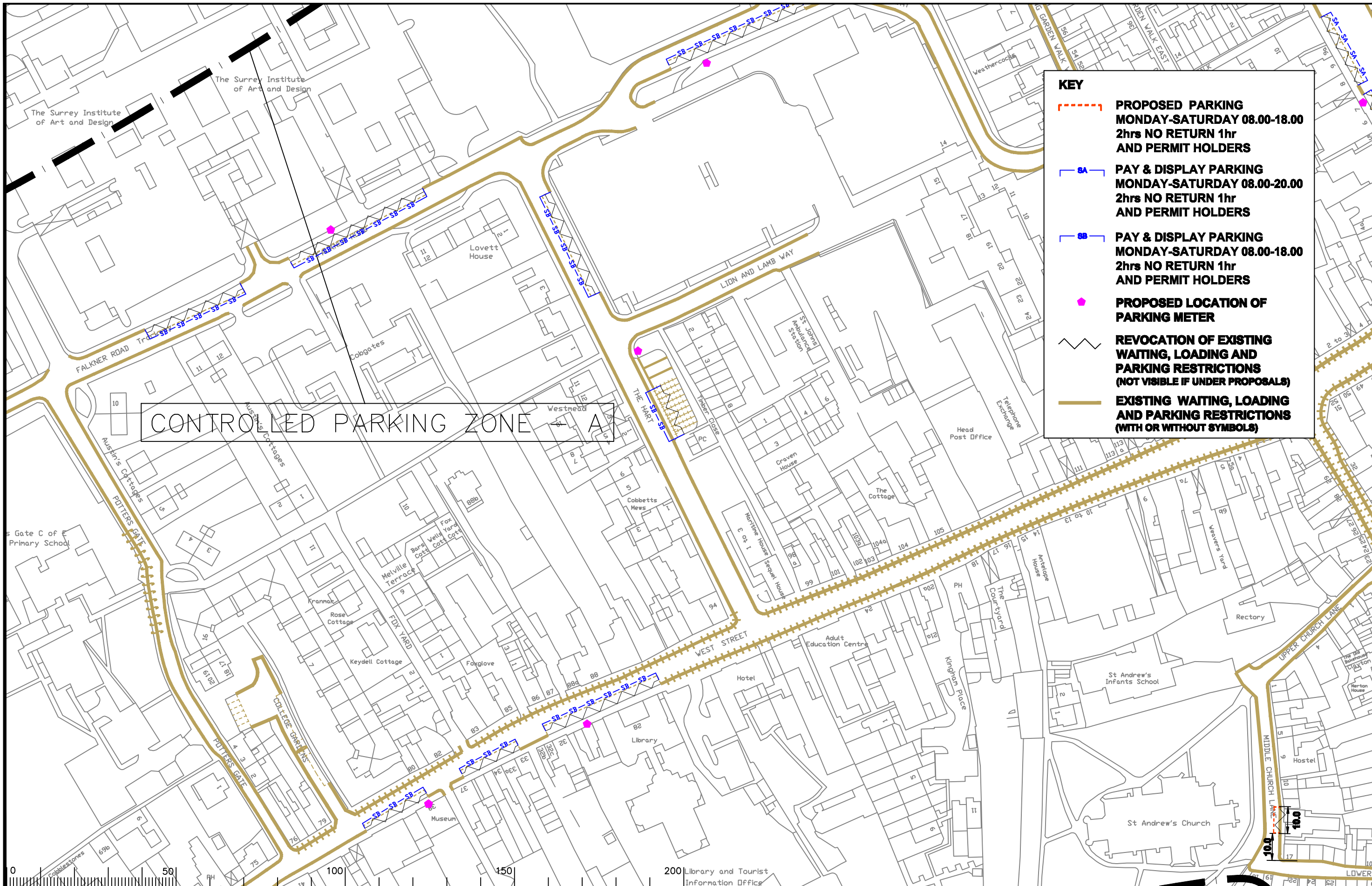

**KEY**

- - - **PROPOSED PARKING MONDAY-SATURDAY 08.00-18.00**  
2hrs NO RETURN 1hr AND PERMIT HOLDERS
- SA - **PAY & DISPLAY PARKING MONDAY-SATURDAY 08.00-20.00**  
2hrs NO RETURN 1hr AND PERMIT HOLDERS
- SB - **PAY & DISPLAY PARKING MONDAY-SATURDAY 08.00-18.00**  
2hrs NO RETURN 1hr AND PERMIT HOLDERS
- **PROPOSED LOCATION OF PARKING METER**
- ~ **REVOCAION OF EXISTING WAITING, LOADING AND PARKING RESTRICTIONS (NOT VISIBLE IF UNDER PROPOSALS)**
- **EXISTING WAITING, LOADING AND PARKING RESTRICTIONS (WITH OR WITHOUT SYMBOLS)**

CONTROLLED PARKING ZONE

Notes

Rev.	Description	Drwn	Sig.	Date	Chkd	Sig.	Date	Appr	Sig.	Date
A	SYMBOLS ADDED TO RESTRICTIONS	SDC	SDC	23.01.08	TPC	TPC	23.01.08	TPC	TPC	23.01.08
B	RESTRICTIONS AMENDED	CAH	CAH	09.11	JAR	JAR	09.11	TPC	TPC	09.11
C	RESTRICTIONS AMENDED	CAH	CAH	09.11	JAR	JAR	09.11	TPC	TPC	09.11

Drwn	Sig.	Date	Chkd	Sig.	Date	Appr	Sig.	Date
SDC	SDC	23.01.08	TPC	TPC	23.01.08	TPC	TPC	23.01.08
CAH	CAH	09.11	JAR	JAR	09.11	TPC	TPC	09.11
CAH	CAH	09.11	JAR	JAR	09.11	TPC	TPC	09.11

North Point

Based upon the Ordnance Survey mapping with the permission of the Controller of Her Majesty's Stationary Office. © Crown copyright. Unauthorised reproduction infringes Crown copyright and may lead to prosecution or civil proceedings. Surrey County Council I.A. 072872.1999.

Drawn by	SDC	Sig.	SDC	Date	03.07
Checked by	TPC	Sig.	TPC	Date	03.07
Approved by	TPC	Sig.	TPC	Date	03.07

Project: WAYERLEY DPE FARNHAM

Classification: IMPLEMENTED TRAFFIC ORDERS

Scale: 1:1250

Project No. 3282/WAV

Contract Sheet No. 24023

**SURREY COUNTY COUNCIL**  
Sustainable Development

Rev. C

Classification: ADVERTISED

SHEET OF